

Flange Insulation

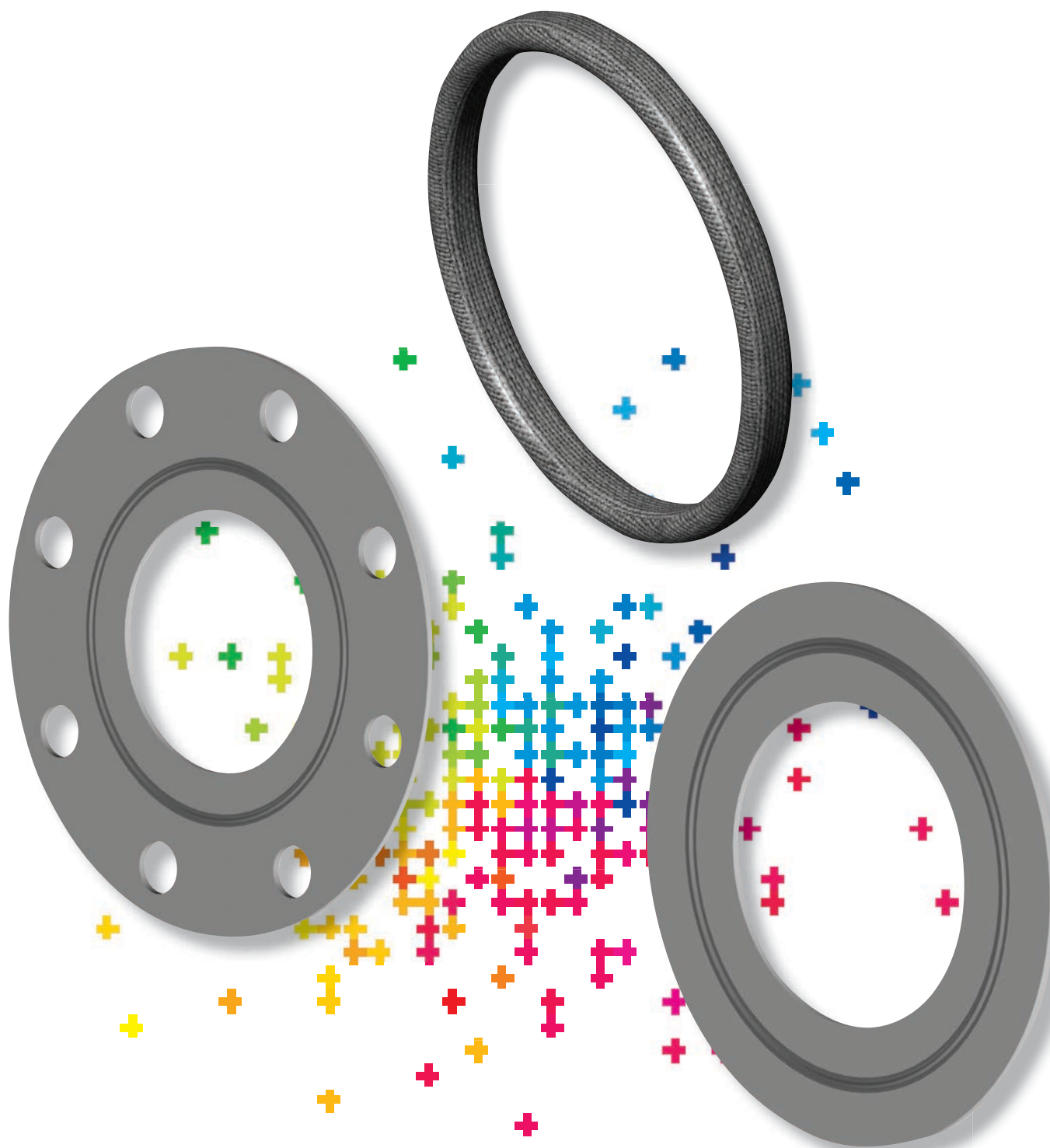

Disclaimer

Information in the catalog

GF Central Plastics is as diligent as possible in compiling and updating the information in its catalog. However, GF Central Plastics does not guarantee the correctness and completeness of the information provided in its catalog. Equally, GF Central Plastics does not guarantee that this information is up to date. Drawings dimensions and weights, unless otherwise noted by tolerances, should be considered for reference only and may not reflect the exact physical measurements of the parts. For questions concerning our products, their specifications and their utilization please contact your local Regional Sales Manager or Customer Service Representative of GF Central Plastics. For comments concerning the product catalog, please email gfccentralmarketing@georgfischer.com.

Flange Connection Insulation: Overview

Flange Insulation

Gaskets are used to create a static compression seal between two stationary members of a mechanical assembly and to maintain that seal under operating conditions which may vary dependent upon changes in pressures and temperatures. In 1960, Central Plastics made the decision to offer a broader range of isolation products into the cathodic protection industry.

GF Central Plastics' Flange Insulation Gaskets and Insulation Kits are used throughout the world and in numerous industry specific applications. Our Gaskets and Flange Insulation Kits have a proven track record of being one of the most effective and reliable products for controlling and maintaining the integrity of piping systems ever under the most demanding conditions.

Gaskets are available individually or in kits. Gasket material includes G3, G7, Nitrile-Face, Plain Phenolic, G10 and Durlon. Sleeve material includes Phenolic, Mylar, Polyethylene, Minlon, or Nomex. Washer materials include Phenolic, Steel, G3, G7 or G10 available as a single washer and sleeve kit, a one piece washer kit, a double washer kit or a one piece double washer kit (Minlon).

Gasket Types

Type E – Full Face Gaskets

Full face gaskets completely cover the flange face from flange bed to outside diameter. Full face gaskets are used on flat faced flanges, however, can be used with a raised flat face flange to eliminate debris building up in raised area causing a short.



Type F – Ring Gasket

Ring Gaskets are designed to set inside the bolt circle and are most commonly used with raised face flanges.



Type D – Ring Type Joint (RTJ)

The RTJ is an oval or octagonal phenolic gasket designed to work specifically with RTJ grooved Flanges. RTJ gaskets are sized by R-number.



Flange Connection Insulation: Overview

Type D – BX

BX gaskets are an octagonal shape phenolic gasket designed to work specifically with a BX grooved flange. An external filler made of 1/16" thick Durlon is supplied with each BX whether is be a complete kit or gasket only. BX gaskets are machined from phenolic tubing; therefore, the gas pressure would be perpendicular to the grain, allowing the gasket to withstand pressures up to 15,000 PSI.



"Jock" O-Ring Type

The "Jock" O-Ring gasket can be a full face (Type E) or ring gasket (Type F) configuration. The "Jock" has a high-energy O-Ring elastomer seal that compresses and expands to fill any voids as the flange is tightened. The totally encapsulated sealing element prevents gasket blow-out. The O-Ring provides a positive, constant seal with zero environmental leakage. Complete contact of flange and retainer prevents fire failure and reduces exposure of the seal to service fluids and environment. The confined O-Ring seal allows zero "m" and "y" factors to be achieved. Available in Nitrile or Viton seal materials.

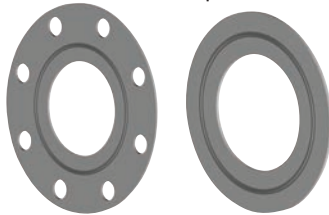

On special request, the "Jock" gasket can replace most sizes of RTJ and BX gaskets. With the versatility of changing the sealing element or the retainer material, the 2" and larger "Jock" gaskets can be utilized in most any application.

Insulating Washers

GF Central Plastics' standard insulating washers are manufactured from CE Phenolic. The maximum operating temperature is approximately 225°F with a compression strength of 36,400 PSI and a dielectric strength of 300 VPM. Our G3 and G7 high temperature insulating washers have a maximum operating temperature of 450°F.

Insulating Sleeves

GF Central Plastics offers insulating sleeves in a variety of materials. Our most standard include Mylar, High Density Polyethylene, and Nomex. They are designed to easily be inserted in the bolt hole, leaving ample room for the bolt, even when the bolt holes are misaligned. The wall thickness is 1/32" and can be provided for bolt sizes from 1/2" to 3 1/2".

Molded One-Piece Sleeve & Washer

The one-piece sleeve and washer reduces handling (many loose parts) and make-up problems in the field. One glance and an inspector can easily tell if the flange has been properly insulated. A Minlon material should be used because of its high compression strength and superior toughness. A one-piece sleeve and washer is most generally used for one-side flange insulation in that we mold it in a sleeve length, that is on an average, significantly longer than the thickness of a single flange. They can be cut to size for two-side insulation. For bolt sizes 1/2"-1 1/4" the maximum operating temperature is 250°F, dielectric strength 420 VPM and compression strength 19,000 PSI.

How to Order Flange Insulation Kits

When talking to your Customer Service Representative, please provide the following information so we can ensure that you are receiving the product that you need:

- Quantity
- Pipe Size (Nominal)
(for sizes larger than 24", the flange ID bore must be specified.)
- Pressure Rating (ANSI/ASME, DIN, API and AWWA)
(If for ANSI/ASME B16.47, Series A or Series B must be specified)
- Gasket Type (Type E or, Type F, RTJ or BX - see below)
- Retainer Material
- Sealing Element
- Single or Double Washer Sets (SW or DW)
- Sleeve Material

Type E Gaskets perfectly center on precisely located bolt holes. Since their outside diameters are the same as the pipe flange diameter, foreign materials is prevented from "shorting" the flange insulation.

Type F Gaskets are made without bolt holes, to fit tightly inside the overall bolt hole circle of the flange faces. The outside diameter of the gasket fits tightly in place assuring a well centered position.

Flange Insulation: Material Legend

Abbreviation	Material
P	Phenolic
N	Nitrile
M	Mylar
PE	Polyethylene
PS	Phenolic Sleeve
MS	Minlon Sleeve
JN	Jock Nitrile
JV	Jock Viton

Mylar®, Nomex®, Minlon®, and Viton® are registered trademarks of E. I. du Pont de Nemours and Company

Durlon® is a registered trademark of Triangle Fluid Control Ltd.

Specifications for Flange Connection Insulation: ASMA Standard Gaskets: B16.21

150 CLASS					
Flange Size	(Number) & Size of Bolts	Ring Gasket I.D.	Ring Gasket O.D.	Full Face Gasket O.D.	RTJ
1"	(4) 1/2"	1"	2 1/2"	4 1/4"	R-15
1 1/4"	(4) 1/2"	1 1/4"	2 7/8"	4 5/8"	R-17
1 1/2"	(4) 1/2"	1 1/2"	3 1/4"	5"	R-19
2"	(4) 5/8"	2"	4"	6"	R-22
2 1/2"	(4) 5/8"	2 1/2"	4 3/4"	7"	R-25
3"	(4) 5/8"	3"	5 1/4"	7 1/2"	R-29
3 1/2"	(8) 5/8"	3 1/2"	6 1/4"	8 1/2"	R-33
4"	(8) 5/8"	4"	6 3/4"	9"	R-36
5"	(8) 3/4"	5"	7 5/8"	10"	R-40
6"	(8) 3/4"	6"	8 5/8"	11"	R-43
8"	(8) 3/4"	8"	10 7/8"	13 1/2"	R-48
10"	(12) 7/8"	10"	13 1/4"	16"	R-52
12"	(12) 7/8"	12"	16"	19"	R-56
14"	(12) 1"	14"	17 5/8"	21"	R-59
16"	(16) 1"	16"	20 1/8"	23 1/2"	R-64
18"	(16) 1 1/8"	18"	21 1/2"	25"	R-68
20"	(20) 1 1/8"	20"	23 3/4"	27 1/2"	R-72
24"	(20) 1 1/4"	24"	28 1/8"	32"	R-76
30"	(28) 1 1/4"	30"	34 5/8"	38 3/4"	
36"	(32) 1 1/2"	36"	41 1/8"	46"	
42"	(36) 1 1/2"	42"	47 7/8"	53"	
48"	(44) 1 1/2"	48"	54 3/8"	59 1/2"	

300 CLASS					
Flange Size	(Number) & Size of Bolts	Ring Gasket I.D.	Ring Gasket O.D.	Full Face Gasket O.D.	RTJ
1"	(4) 5/8"	1"	2 3/4"	4 7/8"	R-16
1 1/4"	(4) 5/8"	1 1/4"	3 1/8"	5 1/4"	R-18
1 1/2"	(4) 3/4"	1 1/2"	3 5/8"	6 1/8"	R-20
2"	(8) 5/8"	2"	4 1/4"	6 1/2"	R-23
2 1/2"	(8) 3/4"	2 1/2"	5"	7 1/2"	R-26
3"	(8) 3/4"	3"	5 3/4"	8 1/4"	R-31
3 1/2"	(8) 3/4"	3 1/2"	6 3/8"	9"	R-34
4"	(8) 3/4"	4"	7"	10"	R-37
5"	(8) 3/4"	5"	8 3/8"	11"	R-41
6"	(12) 3/4"	6"	9 3/4"	12 1/2"	R-45
8"	(12) 7/8"	8"	12"	15"	R-49
10"	(16) 1"	10"	14 1/8"	17 1/2"	R-53
12"	(16) 1 1/8"	12"	16 1/2"	20 1/2"	R-57
14"	(20) 1 1/8"	13 3/4"	19"	23"	R-61
16"	(20) 1 1/4"	15 1/4"	21 1/8"	25 1/2"	R-65
18"	(24) 1 1/4"	17"	23 3/8"	28"	R-69
20"	(24) 1 1/4"	19"	25 5/8"	30 1/2"	R-73
24"	(24) 1 1/2"	23"	30 3/8"	36"	R-77
36"	(32) 2"	35"	43 7/8"	50"	R-98
42"	(36) 2"	41"	50 3/8"	57"	
48"	(40) 2"	47"	52 3/4"	65"	

400 CLASS					
Flange Size	(Number) & Size of Bolts	Ring Gasket I.D.	Ring Gasket O.D.	Full Face Gasket O.D.	RTJ
1"	(4) 5/8"	1"	2 3/4"	4 7/8"	R-16
1 1/4"	(4) 5/8"	1 1/4"	3 1/8"	5 1/4"	R-18
1 1/2"	(4) 3/4"	1 1/2"	3 5/8"	6 1/8"	R-20
2"	(8) 5/8"	2"	4 1/4"	6 1/2"	R-23
2 1/2"	(8) 3/4"	2 1/2"	5"	7 1/2"	R-26
3"	(8) 3/8"	3"	5 3/4"	8 1/4"	R-31
3 1/2"	(8) 7/8"	3 1/2"	6 1/4"	9"	R-34
4"	(8) 7/8"	4"	6 7/8"	10"	R-37
5"	(8) 7/8"	5"	8 1/4"	11"	R-41
6"	(12) 7/8"	6"	9 5/8"	12 1/2"	R-45
8"	(12) 1"	8"	11 7/8"	15"	R-49
10"	(16) 1 1/8"	10"	14"	17 1/2"	R-53
12"	(16) 1 1/4"	12"	16 3/8"	20 1/2"	R-57
14"	(20) 1 1/4"	13 3/8"	18 7/8"	23"	R-61
16"	(20) 1 3/8"	15"	21"	25 1/2"	R-65
18"	(24) 1 3/8"	17"	23 1/4"	28"	R-69
20"	(24) 1 1/2"	18 7/8"	25 3/8"	30 1/2"	R-73
24"	(24) 1 3/4"	22 5/8"	30 3/8"	36"	R-77

600 CLASS					
Flange Size	(Number) & Size of Bolts	Ring Gasket I.D.	Ring Gasket O.D.	Full Face Gasket O.D.	RTJ
1"	(4) 5/8"	1"	2 3/4"	4 7/8"	R-16
1 1/4"	(4) 5/8"	1 1/4"	3 1/8"	5 1/4"	R-18
1 1/2"	(4) 3/4"	1 1/2"	3 5/8"	6 1/8"	R-20
2"	(8) 5/8"	2"	4 1/4"	6 1/2"	R-23
2 1/2"	(8) 3/4"	2 1/2"	5"	7 1/2"	R-26
3"	(8) 3/4"	3"	5 3/4"	8 1/4"	R-31
3 1/2"	(8) 7/8"	3 1/2"	6 1/4"	9"	R-34
4"	(8) 7/8"	4"	7 1/2"	10 3/4"	R-37
5"	(8) 1"	5"	9 3/8"	13"	R-41
6"	(12) 3/4"	6"	10 3/8"	14"	R-45
8"	(12) 1 1/8"	7 7/8"	12 1/2"	16 1/2"	R-49
10"	(16) 1 1/4"	9 3/4"	15 5/8"	20"	R-53
12"	(20) 1 1/4"	11 3/4"	15 5/8"	22"	R-57
14"	(20) 1 3/8"	12 7/8"	19 1/4"	23 3/4"	R-61
16"	(20) 1 1/2"	14 3/4"	22 1/8"	27"	R-65
18"	(20) 1 5/8"	16 1/2"	24"	29 1/4"	R-69
20"	(24) 1 5/8"	18 1/4"	26 3/4"	32"	R-73
24"	(24) 1 7/8"	22"	31"	37"	R-77

Specifications for Flange Connection Insulation: ASME Standard Gaskets: B16.21

900 CLASS					
Flange Size	(Number) & Size of Bolts	Ring Gasket I.D.	Ring Gasket O.D.	Full Face Gasket O.D.	RTJ
1"	(4) 7/8"	7/8"	3"	5 7/8"	R-16
1 1/4"	(4) 7/8"	1 1/8"	3 3/8"	6 1/4"	R-18
1 1/2"	(4) 1"	1 3/8"	3 1/2"	7"	R-20
2"	(8) 7/8"	1 1/8"	5 1/2"	8 1/2"	R-24
2 1/2"	(8) 1"	2 1/4"	6 3/8"	9 5/8"	R-27
3"	(8) 7/8"	2 7/8"	6 1/2"	9 1/2"	R-31
4"	(8) 1 1/8"	3 7/8"	8"	11 1/2"	R-37
5"	(8) 1 1/4"	4 3/4"	9 5/8"	13 3/4"	R-41
6"	(12) 1 1/8"	5 3/4"	11 1/4"	15"	R-45
8"	(12) 1 3/8"	7 1/2"	14"	18 1/2"	R-49
10"	(16) 1 3/8"	9 3/4"	17"	21 1/2"	R-53
12"	(20) 1 3/8"	11 1/8"	19 1/2"	24"	R-57
14"	(20) 1 1/2"	12 1/4"	20 3/8"	25 1/4"	R-62
16"	(20) 1 5/8"	14"	22 1/2"	27 3/4"	R-66
18"	(20) 1 7/8"	15 3/4"	25"	31"	R-70
20"	(20) 2"	17 1/2"	27 3/8"	33 3/4"	R-74

1500 CLASS					
Flange Size	(Number) & Size of Bolts	Ring Gasket I.D.	Ring Gasket O.D.	Full Face Gasket O.D.	RTJ
1"	(4) 7/8"	7/8"	3"	5 7/8"	R-16
1 1/4"	(4) 7/8"	1 1/8"	3 3/8"	6 1/4"	R-18
1 1/2"	(4) 1"	1 3/8"	3 1/2"	7"	R-20
2"	(8) 7/8"	1 1/8"	5 1/2"	8 1/2"	R-24
2 1/2"	(8) 1"	2 1/4"	6 3/8"	9 5/8"	R-27
3"	(8) 1 1/8"	2 3/4"	6 3/4"	10 1/2"	R-35
4"	(8) 1 1/4"	3 5/8"	8 1/8"	12 1/4"	R-39
5"	(8) 1 1/2"	4 3/8"	9 7/8"	14 3/4"	R-44
6"	(12) 1 3/8"	5 3/8"	11"	15 1/2"	R-46
8"	(12) 1 5/8"	7"	13 3/4"	19"	R-50
10"	(12) 7/8"	8 3/4"	17"	23"	R-54
12"	(16) 2"	10 3/8"	20 3/8"	26 1/2"	R-58

2500 CLASS					
Flange Size	(Number) & Size of Bolts	Ring Gasket I.D.	Ring Gasket O.D.	Full Face Gasket O.D.	RTJ
1"	(4) 7/8"	7/8"	3 1/4"	6 1/4"	R-18
1 1/4"	(4) 1"	1 1/8"	4"	7 1/4"	R-21
1 1/2"	(4) 1 1/8"	1 3/8"	4 1/2"	8"	R-23
2"	(8) 1"	1 1/8"	5 5/8"	9 1/4"	R-26
2 1/2"	(8) 1 1/8"	2 1/4"	6 1/2"	10 1/2"	R-28
3"	(8) 1 1/4"	2 3/4"	7 5/8"	12"	R-32
4"	(8) 1 1/2"	3 5/8"	9 1/8"	14"	R-38
5"	(8) 1 3/4"	4 3/8"	10 7/8"	16 1/2"	R-42
6"	(8) 2"	5 3/8"	12 3/8"	19"	R-47
8"	(12) 2"	7"	15 1/8"	21 3/4"	R-51

Wall thickness of sleeves: 1/32"

Thickness of Insulating Washers: 1/8"

Wall thickness of Washer on Nylon Combination Sleeve and Washer: 1/8"

Flange Insulation: Sleeve Quantity and Length Cross Reference

Single Washer Kits

SINGLE WASHER KITS (Qty) Diameter x Length						
Pipe Size	150 Class	300 Class	400 Class	600 Class	900 Class	1500 Class
1/2"	(4) 1/2" x 1 1/8"	(4) 1/2" x 1 3/8"	(4) 1/2" x 1 7/8"	(4) 1/2" x 1 7/8"	(4) 3/4" x 2 1/2"	(4) 3/4" x 2 1/2"
3/4"	(4) 1/2" x 1 1/4"	(4) 5/8" x 1 1/2"	(4) 5/8" x 2"	(4) 5/8" x 2"	(4) 3/4" x 2 3/4"	(4) 3/4" x 2 3/4"
1"	(4) 1/2" x 1 3/8"	(4) 5/8" x 1 5/8"	(4) 5/8" x 2 1/8"	(4) 5/8" x 2 1/8"	(4) 7/8" x 3"	(4) 7/8" x 3"
1 1/4"	(4) 1/2" x 1 1/2"	(4) 3/4" x 1 3/4"	(4) 5/8" x 2 3/8"	(4) 5/8" x 2 3/8"	(4) 7/8" x 3"	(4) 7/8" x 3"
1 1/2"	(4) 1/2" x 1 5/8"	(4) 3/4" x 1 7/8"	(4) 3/4" x 2 1/2"	(4) 3/4" x 2 1/2"	(4) 1" x 3 1/4"	(4) 1" x 3 1/4"
2"	(4) 5/8" x 1 3/4"	(8) 5/8" x 2"	(8) 5/8" x 2 3/4"	(8) 5/8" x 2 3/4"	(8) 7/8" x 3 3/4"	(8) 7/8" x 3 3/4"
2 1/2"	(4) 5/8" x 2"	(8) 3/4" x 2 1/4"	(8) 3/4" x 3"	(8) 3/4" x 3"	(8) 1" x 4"	(8) 1" x 4"
3"	(4) 5/8" x 2 1/8"	(8) 3/4" x 2 1/2"	(8) 3/4" x 3 1/4"	(8) 3/4" x 3 1/4"	(8) 7/8" x 3 3/4"	(8) 1 1/8" x 4 1/2"
3 1/2"	(8) 5/8" x 2 1/8"	(8) 3/4" x 2 5/8"	(8) 7/8" x 3 1/2"	(8) 7/8" x 3 1/2"		
4"	(8) 5/8" x 2 1/8"	(8) 3/4" x 2 3/4"	(8) 7/8" x 3 1/2"	(8) 7/8" x 3 3/4"	(8) 1 1/8" x 4 1/4"	(8) 1 1/4" x 5"
5"	(8) 3/4" x 2 1/8"	(8) 3/4" x 3 1/8"	(8) 7/8" x 3 3/4"	(8) 1" x 4 1/4"	(8) 1 1/4" x 4 3/4"	(8) 1 1/2" x 6 1/2"
6"	(8) 3/4" x 2 1/4"	(12) 3/4" x 3 1/4"	(12) 7/8" x 4"	(12) 1" x 4 1/2"	(12) 1 1/8" x 5 1/8"	(12) 1 3/8" x 7 1/4"
8"	(8) 3/4" x 2 1/2"	(12) 7/8" x 3 1/2"	(12) 1" x 4 1/2"	(12) 1 1/8" x 5 1/8"	(12) 1 3/8" x 5 3/4"	(12) 1 5/8" x 8"
10"	(12) 7/8" x 2 5/8"	(16) 1" x 4"	(16) 1 1/8" x 5"	(16) 1 1/4" x 5 3/4"	(16) 1 3/8" x 6 1/4"	(12) 1 7/8" x 9 1/4"
12"	(12) 7/8" x 2 3/4"	(16) 1 1/8" x 4 1/4"	(16) 1 1/4" x 5 1/4"	(20) 1 1/4" x 6"	(20) 1 3/8" x 7"	(16) 2" x 10 1/2"
14"	(12) 1" x 3"	(20) 1 1/8" x 4 1/2"	(20) 1 1/4" x 5 1/2"	(20) 1 3/8" x 6 1/4"	(20) 1 1/2" x 7 1/2"	
16"	(16) 1" x 3 1/8"	(20) 1 1/4" x 4 3/4"	(20) 1 3/8" x 5 3/4"	(20) 1 1/2" x 6 3/4"	(20) 1 5/8" x 7 3/4"	
18"	(16) 1 1/8" x 3 3/8"	(24) 1 1/4" x 5"	(24) 1 3/8" x 6"	(20) 1 5/8" x 7 1/4"	(20) 1 7/8" x 8 3/4"	
20"	(20) 1 1/8" x 3 5/8"	(24) 1 1/4" x 5 1/4"	(24) 1 1/2" x 6 1/4"	(24) 1 5/8" x 7 3/4"	(20) 2" x 9 1/4"	
22"	(20) 1 1/4" x 3 7/8"	(24) 1 1/2" x 5 1/2"	(24) 1 5/8" x 6 1/2"	(24) 1 3/4" x 8 1/4"		
24"	(20) 1 1/4" x 4"	(24) 1 1/2" x 5 3/4"	(24) 1 3/4" x 6 3/4"	(24) 1 7/8" x 8 3/4"		
26"	(20) 1 1/4" x 4 1/4"	(28) 1 5/8" x 6 1/2"	(28) 1 3/4" x 7 3/4"	(28) 1 7/8" x 9 1/4"		
28"	(28) 1 1/4" x 4 3/8"	(28) 1 5/8" x 7"	(28) 1 7/8" x 8 1/4"	(28) 2" x 9 1/2"		
30"	(28) 1 1/4" x 4 1/2"	(28) 1 3/4" x 7 1/2"	(28) 2" x 8 3/4"	(28) 2" x 9 3/4"		
32"	(28) 1 1/2" x 4 3/4"	(28) 1 7/8" x 8"	(28) 2" x 9 1/4"			
34"	(32) 1 1/2" x 4 3/4"	(28) 1 7/8" x 8 1/4"	(28) 2" x 9 1/2"			
36"	(32) 1 1/2" x 5"	(32) 2" x 8 1/2"	(32) 2" x 9 3/4"			
38"	(32) 1 1/2" x 7 1/8"	(32) 1 1/2" x 8 3/4"	(32) 1 3/4" x 10 1/2"	(28) 2 1/4" x 12 3/4"		
40"	(36) 1 1/2" x 7 3/8"	(32) 1 5/8" x 9 1/4"	(32) 1 7/8" x 11"	(32) 2 1/4" x 13 1/4"		
42"	(36) 1 1/2" x 7 7/8"	(32) 1 5/8" x 9 5/8"	(32) 1 7/8" x 11 1/4"	(28) 2 1/2" x 14"		
44"	(40) 1 1/2" x 8 1/4"	(32) 1 3/4" x 10"	(32) 2" x 11 3/4"	(32) 2 1/2" x 14 3/8"		
46"	(40) 1 1/2" x 8 3/8"	(28) 1 7/8" x 10 3/8"	(36) 2" x 12 1/4"	(32) 2 1/2" x 14 3/8"		
48"	(44) 1 1/2" x 8 3/4"	(32) 1 7/8" x 10 3/4"	(28) 2 1/4" x 12 3/4"	(32) 2 3/4" x 15 5/8"		
50"	(44) 1 3/4" x 9"	(32) 2" x 11 1/4"	(32) 2 1/4" x 13 1/8"	(28) 3" x 16 1/4"		
52"	(44) 1 3/4" x 9 3/8"	(32) 2" x 11 5/8"	(32) 2 1/4" x 13 1/2"	(32) 3" x 16 3/4"		
54"	(44) 1 3/4" x 9 3/4"	(28) 2 1/4" x 12 1/4"	(28) 2 1/2" x 14 1/8"	(32) 3" x 17 1/4"		
56"	(48) 1 3/4" x 10"	(28) 2 1/4" x 12 3/8"	(32) 2 1/2" x 14 1/2"	(32) 3 1/4" x 17 7/8"		
58"	(48) 1 3/4" x 10 3/8"	(32) 2 1/4" x 12 3/4"	(32) 2 1/2" x 14 3/4"	(32) 3 1/4" x 18 1/4"		
60"	(52) 1 3/4" x 10 5/8"	(32) 2 1/4" x 13 1/8"	(32) 2 3/4" x 15 3/8"	(28) 3 1/2" x 19 1/8"		

NOTE: QTY listed for double washer kits represents quantity of sleeves only. The quantity of washers will be double the quantity of sleeves provided. [i.e. (4) sleeves = (8) washers, (12) sleeves = (24) washers]

Larger sizes and high temperature sets available on request.

Unless otherwise specified, all kits will be shipped with one (1) full length insulating Mylar® sleeve, one (1) insulating phenolic washer, and one (1) zinc plated steel washer per bolt.

Flange Insulation: Sleeve Quantity and Length Cross Reference

Double Washer Kits

DOUBLE WASHER KITS (Qty Sleeves)** Diameter x Length						
Pipe Size	150 Class	300 Class	400 Class	600 Class	900 Class	1500 Class
1/2"	(4) 1/2" x 1 1/4"	(4) 1/2" x 1 1/2"	(4) 1/2" x 2"	(4) 1/2" x 2"	(4) 3/4" x 2 5/8"	(4) 3/4" x 2 5/8"
3/4"	(4) 1/2" x 1 3/8"	(4) 5/8" x 1 5/8"	(4) 5/8" x 2 1/8"	(4) 5/8" x 2 1/8"	(4) 3/4" x 2 7/8"	(4) 3/4" x 2 7/8"
1"	(4) 1/2" x 1 1/2"	(4) 5/8" x 1 3/4"	(4) 5/8" x 2 1/4"	(4) 5/8" x 2 1/4"	(4) 7/8" x 3 1/8"	(4) 7/8" x 3 1/8"
1 1/4"	(4) 1/2" x 1 5/8"	(4) 5/8" x 1 7/8"	(4) 5/8" x 2 1/2"	(4) 5/8" x 2 1/2"	(4) 7/8" x 3 1/8"	(4) 7/8" x 3 1/8"
1 1/2"	(4) 1/2" x 1 3/4"	(4) 3/4" x 2"	(4) 3/4" x 2 5/8"	(4) 3/4" x 2 5/8"	(4) 1" x 3 3/8"	(4) 1" x 3 3/8"
2"	(4) 5/8" x 1 7/8"	(8) 5/8" x 2 1/8"	(8) 5/8" x 2 7/8"	(8) 5/8" x 2 7/8"	(8) 7/8" x 3 3/8"	(8) 7/8" x 3 3/8"
2 1/2"	(4) 5/8" x 2 1/8"	(8) 3/4" x 2 3/8"	(8) 3/4" x 3 1/8"	(8) 3/4" x 3 1/8"	(8) 1" x 4 1/8"	(8) 1" x 4 1/8"
3"	(4) 5/8" x 2 1/4"	(8) 3/4" x 2 5/8"	(8) 3/4" x 3 3/8"	(8) 3/4" x 3 3/8"	(8) 7/8" x 3 3/8"	(8) 1 1/8" x 4 5/8"
3 1/2"	(8) 5/8" x 2 1/4"	(8) 3/4" x 2 3/4"	(8) 7/8" x 3 5/8"	(8) 7/8" x 3 5/8"		
4"	(8) 5/8" x 2 1/4"	(8) 3/4" x 2 7/8"	(8) 7/8" x 3 5/8"	(8) 7/8" x 4 7/8"	(8) 1 1/8" x 4 3/8"	(8) 1 1/4" x 5 1/8"
5"	(8) 3/4" x 2 1/4"	(8) 3/4" x 2 1/4"	(8) 7/8" x 3 7/8"	(8) 1" x 4 3/8"	(8) 1 1/4" x 4 7/8"	(8) 1 1/2" x 7 5/8"
6"	(8) 3/4" x 2 3/8"	(12) 3/4" x 3 3/8"	(12) 7/8" x 4 1/8"	(12) 1" x 4 5/8"	(12) 1 1/8" x 5 1/4"	(12) 1 3/8" x 7 3/8"
8"	(8) 3/4" x 2 5/8"	(12) 7/8" x 3 3/8"	(12) 1" x 4 5/8"	(12) 1 1/8" x 5 1/4"	(12) 1 3/8" x 5 7/8"	(12) 1 5/8" x 8 1/8"
10"	(12) 7/8" x 2 3/4"	(16) 1" x 4 1/8"	(16) 1 1/8" x 5 1/8"	(16) 1 1/4" x 5 7/8"	(16) 1 3/8" x 6 3/8"	(12) 1 7/8" x 9 3/8"
12"	(12) 7/8" x 2 7/8"	(16) 1 1/8" x 4 3/8"	(16) 1 1/4" x 5 3/8"	(20) 1 1/4" x 6 1/8"	(20) 1 3/8" x 7 1/8"	(16) 2" x 10 5/8"
14"	(12) 1" x 3 1/8"	(20) 1 1/8" x 4 5/8"	(20) 1 1/4" x 5 5/8"	(20) 1 3/8" x 6 3/8"	(20) 1 1/2" x 7 5/8"	
16"	(16) 1" x 3 1/4"	(20) 1 1/4" x 4 7/8"	(20) 1 3/8" x 5 7/8"	(20) 1 1/2" x 6 7/8"	(20) 1 5/8" x 7 7/8"	
18"	(16) 1 1/8" x 3 1/2"	(24) 1 1/4" x 5 1/8"	(24) 1 3/8" x 6 1/8"	(20) 1 5/8" x 7 3/8"	(20) 1 7/8" x 8 7/8"	
20"	(20) 1 1/8" x 3 3/4"	(24) 1 1/4" x 5 3/8"	(24) 1 1/2" x 6 3/8"	(24) 1 5/8" x 7 7/8"	(20) 2" x 9 3/8"	
22"	(20) 1 1/4" x 4"	(24) 1 1/2" x 5 5/8"	(24) 1 5/8" x 6 5/8"	(24) 1 3/4" x 8 3/8"		
24"	(20) 1 1/4" x 4 1/8"	(24) 1 1/2" x 5 7/8"	(24) 1 3/4" x 6 7/8"	(24) 1 7/8" x 8 7/8"		
26"	(20) 1 1/4" x 4 3/8"	(28) 1 5/8" x 6 3/8"	(28) 1 3/4" x 7 7/8"	(28) 1 7/8" x 9 3/8"		
28"	(28) 1 1/4" x 4 1/2"	(28) 1 5/8" x 7 1/8"	(28) 1 7/8" x 8 3/8"	(28) 2" x 9 5/8"		
30"	(28) 1 1/4" x 4 5/8"	(28) 1 3/4" x 7 5/8"	(28) 2" x 8 7/8"	(28) 2" x 9 7/8"		
32"	(28) 1 1/2" x 4 7/8"	(28) 1 7/8" x 8 1/8"	(28) 2" x 9 3/8"			
34"	(32) 1 1/2" x 8"	(28) 1 7/8" x 8 3/8"	(28) 2" x 9 5/8"			
36"	(32) 1 1/2" x 5 1/8"	(32) 2" x 8 5/8"	(32) 2" x 9 7/8"			
38"	(32) 1 1/2" x 7 1/4"	(32) 1 1/2" x 8 7/8"	(32) 1 3/4" x 10 5/8"	(28) 2 1/4" x 12 7/8"		
40"	(36) 1 1/2" x 7 1/2"	(32) 1 5/8" x 9 3/8"	(32) 1 7/8" x 11 1/8"	(32) 2 1/4" x 13 3/8"		
42"	(36) 1 1/2" x 8"	(32) 1 5/8" x 9 3/4"	(32) 1 7/8" x 11 3/8"	(28) 2 1/2" x 14 1/8"		
44"	(40) 1 1/2" x 8 3/8"	(32) 1 3/4" x 10 1/8"	(32) 2" x 11 7/8"	(32) 2 1/2" x 14 1/2"		
46"	(40) 1 1/2" x 8 1/2"	(28) 1 7/8" x 10 1/2"	(36) 2" x 12 3/8"	(32) 2 1/2" x 15"		
48"	(44) 1 1/2" x 8 7/8"	(32) 1 7/8" x 10 7/8"	(28) 2 1/4" x 12 7/8"	(32) 2 3/4" x 15 3/4"		
50"	(44) 1 3/4" x 9 1/8"	(32) 2" x 11 3/8"	(32) 2 1/4" x 13 1/4"	(28) 3" x 16 3/8"		
52"	(44) 1 3/4" x 9 1/2"	(32) 2" x 11 3/4"	(32) 2 1/4" x 13 5/8"	(32) 3" x 16 7/8"		
54"	(44) 1 3/4" x 9 7/8"	(28) 2 1/4" x 12 3/8"	(28) 2 1/2" x 14 1/4"	(32) 3" x 17 3/8"		
56"	(48) 1 3/4" x 10 1/8"	(28) 2 1/4" x 12 1/2"	(32) 2 1/2" x 14 5/8"	(32) 3 1/4" x 18"		
58"	(48) 1 3/4" x 10 1/2"	(32) 2 1/4" x 12 7/8"	(32) 2 1/2" x 14 7/8"	(32) 3 1/4" x 18 3/8"		
60"	(52) 1 3/4" x 10 3/4"	(32) 2 1/4" x 13 1/4"	(32) 2 3/4" x 15 1/2"	(28) 3 1/2" x 19 1/4"		

NOTE: QTY listed for double washer kits represents quantity of sleeves only. The quantity of washers will be double the quantity of sleeves provided. [i.e. (4) sleeves = (8) washers, (12) sleeves = (24) washers]

Larger sizes and high temperature sets available on request.

Unless otherwise specified, all kits will be shipped with one (1) full length insulating Mylar® sleeve, two (2) insulating phenolic washers, and two (2) zinc plated steel washers per bolt.

Flange Insulation: Tubing Materials List

Bolt Size	3 FT LENGTH					INCH LENGTH					LENGTH	mm LENGTH
	Mylar®	Poly	Phen	G10 Tubing	Nomex®	Mylar®	Poly	Phen	G10 Tubing	Nomex®	Bolt Size	Mylar®
1/2"	•	•	•	•	•	•	•	•	•	•	M12	•
5/8"	•	•	•	•	•	•	•	•	•	•	M16	•
3/4"	•	•	•	•	•	•	•	•	•	•	M20	•
7/8"	•	•	•	•	•	•	•	•	•	•	M24	•
1"	•	•	•	•	•	•	•	•	•	•	M27	•
1 1/8"	•	•	•	•	•	•	•	•	•	•	M30	•
1 1/4"	•	•	•	•	•	•	•	•	•	•	M33	•
1 3/8"	•	•	•	•	•	•	•	•	•	•	M36	•
1 1/2"	•	•	•	•	•	•	•	•	•	•	M39	•
1 5/8"	•	•	•	•	•	•	•	•	•	•		
1 3/4"	•	•	•	•	•	•	•	•	•	•	M45	•
1 7/8"	•	•	•	•	•	•	•	•	•	•		
2"	•	•	•	•	•	•	•	•	•	•	M52	•
2 1/4"	•	•	•	•	•	•	•	•	•	•	M56	•
2 1/2"	•	•	•	•	•	•	•	•	•	•		
2 3/4"	•	•	•	•	•	•	•	•	•	•		
3"	•	•	•	•	•	•	•	•	•	•		
3 1/2"	•	•	•	•	•	•	•	•	•	•		

Larger sizes and high temperature sets and custom builds available on request.

Unless otherwise specified, all kits will be shipped with one (1) full length insulating Mylar® sleeve, two (2) insulating phenolic washers, and two (2) zinc plated steel washers per bolt.

Flange Insulation: Washer Material List

WASHER				SLEEVE & WASHER COMBO	
Bolt Size	Steel	Phenolic	G3, G7 & G10	Bolt Size	Minlon®
1/2"	•	•	•	1/2" x 1"	•
5/8"	•	•	•	5/8" x 1"	•
3/4"	•	•	•	5/8" x 1 1/4"	•
7/8"	•	•	•	3/4" x 1 1/16"	•
1"	•	•	•	7/8" x 1 13/16"	•
1 1/8"	•	•	•	1" x 2 5/16"	•
1 1/4"	•	•	•	1 1/8" x 2 1/2"	•
1 3/8"	•	•	•	1 1/4" x 3 3/16"	•
1 1/2"	•	•	•		
1 5/8"	•	•	•		
1 3/4"	•	•	•		
1 7/8"	•	•	•		
2"	•	•	•		
2 1/4"	•	•	•		
2 1/2"	•	•	•		
2 3/4"	•	•	•		
3"	•	•	•		
3 1/4"	•	•	•		
3 1/2"	•	•	•		

Larger sizes, high temperature sets, and custom builds available. Unless otherwise specified, all kits will be shipped with one (1) full length insulating Mylar® sleeve, two (2) insulating phenolic washers, and two (2) zinc plated steel washers per bolt.

Flange Insulation: Sleeve ID and OD Reference Sheet

SLEEVE			SLEEVE		
Bolt Size	ID	OD	Bolt Size	ID	OD
3/8"	0.394"	0.474"	M10	0.413"	0.453"
1/2"	0.519"	0.599"	M12	0.491"	0.532"
5/8"	0.644"	0.724"	M16	0.649"	0.690"
3/4"	0.767"	0.849"	M20	0.806"	0.847"
7/8"	0.894"	0.974"	M24	0.964"	1.005"
1"	1.019"	1.099"	M27	1.082"	1.162"
1 1/8"	1.144"	1.224"	M30	1.200"	1.280"
1 1/4"	1.269"	1.349"	M33	1.318"	1.398"
1 3/8"	1.394"	1.474"	M36	1.436"	1.516"
1 1/2"	1.519"	1.599"	M39	1.554"	1.634"
1 5/8"	1.644"	1.724"	M45	1.791"	1.871"
1 3/4"	1.769"	1.849"	M48	1.909"	1.989"
1 7/8"	1.894"	1.974"	M52	2.066"	2.146"
2"	2.019"	2.099"	M56	2.224"	2.422"
2 1/4"	2.269"	2.349"	M64	2.539"	2.658"
2 1/2"	2.519"	2.599"			
2 3/4"	2.781"	2.849"			
3"	3.019"	3.099"			
3 1/2"	3.531"	3.591"			

Larger sizes, high temperature sets, and custom builds available on request. Unless otherwise specified, all kits will be shipped with one (1) full length insulating Mylar® sleeve, two (2) insulating phenolic washers, and two (2) zinc plated steel washers per bolt.

Flange Kit Weights: Type E (Full Face) and Type F (Ring)

Single Washer and Double Washer Kits

TYPE F GASKET KIT WEIGHTS

	SINGLE WASHER KITS			DOUBLE WASHER KITS		
	150#	300#	600#	150 #	300#	600#
1"	0.26	0.28	0.32	0.34	0.38	0.48
2"	0.36	0.54	0.54	0.46	1.18	1.20
2½"	0.36	0.82	0.86	0.48	1.20	1.35
3"	0.40	0.92	0.92	0.50	1.28	1.48
4"	0.78	0.96	1.02	1.08	1.34	1.82
6"	1.00	1.56	2.26	1.38	1.76	3.52
8"	1.26	1.96	2.84	1.64	2.88	4.24
10"	2.00	3.08	5.54	3.20	4.64	8.56
12"	3.04	4.98	6.86	4.08	6.30	10.26
14"				4.42	8.30	11.08
16"	3.92	6.60	11.06	5.82	9.92	16.70
18"	4.10		8.86	6.20		
20"	6.48		10.36	8.36	13.30	15.32
24"			14.28	12.00	20.70	21.27

TYPE E GASKET KIT WEIGHTS

	SINGLE WASHER KITS			DOUBLE WASHER KITS		
	150#	300#	600#	150#	300#	600#
1"	0.32	0.34	0.36	0.38	0.45	0.55
2"	0.40	0.56	0.76	0.58		1.02
2½"	0.60	0.98	1.02	0.74	1.36	
3"	0.62	0.98	1.04	0.76	1.44	1.48
4"	0.84	1.36	2.26	1.20	1.92	2.44
6"	1.24	1.78		1.76	2.42	4.24
8"	1.60	2.32	4.16	2.18	4.06	5.90
10"	3.00	4.22	5.82	4.04	5.52	9.52
12"		5.14	7.16	4.44	7.18	10.26
14"	4.20			4.84	10.10	15.60
16"	5.64	8.76	11.58	7.76	11.40	17.46
18"	6.36			8.68	15.46	
20"	7.24	11.26	12.68	10.12	15.24	17.46
24"	9.84	12.28		13.56		

Larger sizes, high temperature sets, and custom builds available on request. Unless otherwise specified, all kits will be shipped with one (1) full length insulating Mylar® sleeve, two (2) insulating phenolic washers, and two (2) zinc plated steel washers per bolt.

Flange Insulation: Nitrile-Face and Plain Phenolic Gasket Kits Type "E" (Full Face)



Sleeves: **Mylar® and Poly Only (•): Mylar®, Poly and Minlon® (••); Washers: Phenolic**

Single Washer Kits



Double Washer Kits

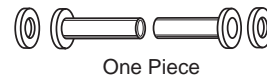

Pipe Size	SINGLE WASHER KITS						DOUBLE WASHER KITS					
	150 Class	300 Class	400 Class	600 Class	900 Class	1500 Class	150 Class	300 Class	400 Class	600 Class	900 Class	1500 Class
¾"	•	•	•	•	•	•	•	•	•	•	•	•
1"	•	•	•	•	•	•	•	•	•	•	•	•
1¼"	•	•	•	•	•	•	•	•	•	•	•	•
1½"	•	•	•	•	•	•	•	•	•	•	•	•
2"	•	•	•	•	•	•	•	•	•	•	•	•
2½"	•	•	•	•	•	•	•	•	•	•	•	•
3"	•	•	•	•	•	•	•	•	•	•	•	•
3½"	•	•	•	•	•	•	•	•	•	•	•	•
4"	•	•	•	•	•	•	•	•	•	•	•	•
5"	•	•	•	•	•	•	•	•	•	•	•	•
6"	•	•	•	•	•	•	•	•	•	•	•	•
8"	•	•	•	•	•	•	•	•	•	•	•	•
10"	•	•	•	•	•	•	•	•	•	•	•	•
12"	•	•	•	•	•	•	•	•	•	•	•	•
14"	•	•	•	•	•	•	•	•	•	•	•	•
16"	•	•	•	•	•	•	•	•	•	•	•	•
18"	•	•	•	•	•	•	•	•	•	•	•	•
20"	•	•	•	•	•	•	•	•	•	•	•	•
22"	•	•	•	•	•	•	•	•	•	•	•	•
24"	•	•	•	•	•	•	•	•	•	•	•	•
26"	•	•	•	•	•	•	•	•	•	•	•	•
28"	•	•	•	•	•	•	•	•	•	•	•	•
30"	•	•	•	•	•	•	•	•	•	•	•	•
32"	•	•	•	•	•	•	•	•	•	•	•	•
34"	•	•	•	•	•	•	•	•	•	•	•	•
36"	•	•	•	•	•	•	•	•	•	•	•	•

Larger sizes, high temperature sets (G3, G7 and G10) and custom builds available on request.

Unless otherwise specified, all kits will be shipped with one (1) full length insulating Mylar® sleeve, two (2) insulating phenolic washers, and two (2) zinc plated steel washers per bolt.

Flange Insulation: Nitrile-Faced and Plain Phenolic Gasket Kits Type "F" (Ring)



Sleeves: **Mylar® and Poly Only (•): Mylar®, Poly and Minlon® (•);**
Washers: **Phenolic**

Single Washer Kits



Double Washer Kits

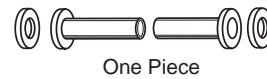

Pipe Size	SINGLE WASHER KITS						DOUBLE WASHER KITS					
	150 Class	300 Class	400 Class	600 Class	900 Class	1500 Class	150 Class	300 Class	400 Class	600 Class	900 Class	1500 Class
¾"	•	•	•	•	•	•	•	•	•	•	•	•
1"	•	•	•	•	•	•	•	•	•	•	•	•
1¼"	•	•	•	•	•	•	•	•	•	•	•	•
1½"	•	•	•	•	•	•	•	•	•	•	•	•
2"	•	•	•	•	•	•	•	•	•	•	•	•
2½"	•	•	•	•	•	•	•	•	•	•	•	•
3"	•	•	•	•	•	•	•	•	•	•	•	•
3½"	•	•	•	•	•	•	•	•	•	•	•	•
4"	•	•	•	•	•	•	•	•	•	•	•	•
5"	•	•	•	•	•	•	•	•	•	•	•	•
6"	•	•	•	•	•	•	•	•	•	•	•	•
8"	•	•	•	•	•	•	•	•	•	•	•	•
10"	•	•	•	•	•	•	•	•	•	•	•	•
12"	•	•	•	•	•	•	•	•	•	•	•	•
14"	•	•	•	•	•	•	•	•	•	•	•	•
16"	•	•	•	•	•	•	•	•	•	•	•	•
18"	•	•	•	•	•	•	•	•	•	•	•	•
20"	•	•	•	•	•	•	•	•	•	•	•	•
22"	•	•	•	•	•	•	•	•	•	•	•	•
24"	•	•	•	•	•	•	•	•	•	•	•	•
26"	•	•	•	•	•	•	•	•	•	•	•	•
28"	•	•	•	•	•	•	•	•	•	•	•	•
30"	•	•	•	•	•	•	•	•	•	•	•	•
32"	•	•	•	•	•	•	•	•	•	•	•	•
34"	•	•	•	•	•	•	•	•	•	•	•	•
36"	•	•	•	•	•	•	•	•	•	•	•	•

Larger sizes, high temperature sets (G3, G7 & G10) and custom builds available on request.

Unless otherwise specified, all kits will be shipped with one (1) full length insulating Mylar® sleeve, two (2) insulating phenolic washers, and two (2) zinc plated steel washers per bolt.

Flange Insulation: Nitrile-Face and Plain Phenolic Gaskets Only Type "E" (Full Face) and Type "F" (Ring)

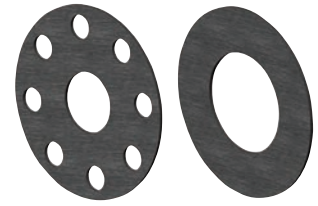

Pipe Size	TYPE "E" GASKETS						TYPE "F" GASKETS					
	150 Class	300 Class	400 Class	600 Class	900 Class	1500 Class	150 Class	300 Class	400 Class	600 Class	900 Class	1500 Class
¾"	•	•	•	•	•	•	•	•	•	•	•	•
1"	•	•	•	•	•	•	•	•	•	•	•	•
1¼"	•	•	•	•	•	•	•	•	•	•	•	•
1½"	•	•	•	•	•	•	•	•	•	•	•	•
2"	•	•	•	•	•	•	•	•	•	•	•	•
2½"	•	•	•	•	•	•	•	•	•	•	•	•
3"	•	•	•	•	•	•	•	•	•	•	•	•
3½"	•	•	•	•	•	•	•	•	•	•	•	•
4"	•	•	•	•	•	•	•	•	•	•	•	•
5"	•	•	•	•	•	•	•	•	•	•	•	•
6"	•	•	•	•	•	•	•	•	•	•	•	•
8"	•	•	•	•	•	•	•	•	•	•	•	•
10"	•	•	•	•	•	•	•	•	•	•	•	•
12"	•	•	•	•	•	•	•	•	•	•	•	•
14"	•	•	•	•	•	•	•	•	•	•	•	•
16"	•	•	•	•	•	•	•	•	•	•	•	•
18"	•	•	•	•	•	•	•	•	•	•	•	•
20"	•	•	•	•	•	•	•	•	•	•	•	•
22"	•	•	•	•	•	•	•	•	•	•	•	•
24"	•	•	•	•	•	•	•	•	•	•	•	•
26"	•	•	•	•	•	•	•	•	•	•	•	•
28"	•	•	•	•	•	•	•	•	•	•	•	•
30"	•	•	•	•	•	•	•	•	•	•	•	•
32"	•	•	•	•	•	•	•	•	•	•	•	•
34"	•	•	•	•	•	•	•	•	•	•	•	•
36"	•	•	•	•	•	•	•	•	•	•	•	•

Larger sizes, high temperature sets (G3, G7 and G10) and custom builds available on request.

Unless otherwise specified, all kits will be shipped with one (1) full length insulating Mylar® sleeve, two (2) insulating phenolic washers, and two (2) zinc plated steel washers per bolt.

Flange Insulation: Sleeve and Washer Kits Only

Sleeves: Mylar® and Poly Only (•): Mylar®, Poly and Minlon® (••); Washers: Phenolic

Single Washer Kits



Double Washer Kits

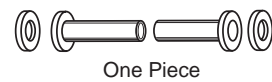

Pipe Size	SINGLE WASHER KITS						DOUBLE WASHER KITS					
	150 Class	300 Class	400 Class	600 Class	900 Class	1500 Class	150 Class	300 Class	400 Class	600 Class	900 Class	1500 Class
¾"	•	•	•	•	•	•	•	•	•	•	•	•
1"	•	•	•	•	•	•	•	•	•	•	•	•
1¼"	•	•	•	•	•	•	•	•	•	•	•	•
1½"	•	•	•	•	•	•	•	•	•	•	•	•
2"	•	•	•	•	•	•	•	•	•	•	•	•
2½"	•	•	•	•	•	•	•	•	•	•	•	•
3"	•	•	•	•	•	•	•	•	•	•	•	•
3½"	•	•	•	•	•	•	•	•	•	•	•	•
4"	•	•	•	•	•	•	•	•	•	•	•	•
5"	•	•	•	•	•	•	•	•	•	•	•	•
6"	•	•	•	•	•	•	•	•	•	•	•	•
8"	•	•	•	•	•	•	•	•	•	•	•	•
10"	•	•	•	•	•	•	•	•	•	•	•	•
12"	•	•	•	•	•	•	•	•	•	•	•	•
14"	•	•	•	•	•	•	•	•	•	•	•	•
16"	•	•	•	•	•	•	•	•	•	•	•	•
18"	•	•	•	•	•	•	•	•	•	•	•	•
20"	•	•	•	•	•	•	•	•	•	•	•	•
22"	•	•	•	•	•	•	•	•	•	•	•	•
24"	•	•	•	•	•	•	•	•	•	•	•	•
26"	•	•	•	•	•	•	•	•	•	•	•	•
28"	•	•	•	•	•	•	•	•	•	•	•	•
30"	•	•	•	•	•	•	•	•	•	•	•	•
32"	•	•	•	•	•	•	•	•	•	•	•	•
34"	•	•	•	•	•	•	•	•	•	•	•	•
36"	•	•	•	•	•	•	•	•	•	•	•	•

Larger sizes, high temperature sets and custom builds available on request.

Unless otherwise specified, all kits will be shipped with one (1) full length insulating Mylar® sleeve, two (2) insulating phenolic washers, and two (2) zinc plated steel washers per bolt.

Flange Insulation: Sleeve and Washer Kits Only

Sleeves: Mylar®; Washers: Phenolic

Single Washer Kits



Double Washer Kits



Pipe Size	SINGLE WASHER KITS				DOUBLE WASHER KITS			
	150 Class	300 Class	400 Class	600 Class	150 Class	300 Class	400 Class	600 Class
38"	•	•	•	•	•	•	•	•
40"	•	•	•	•	•	•	•	•
42"	•	•	•	•	•	•	•	•
44"	•	•	•	•	•	•	•	•
46"	•	•	•	•	•	•	•	•
48"	•	•	•	•	•	•	•	•
50"	•	•	•	•	•	•	•	•
52"	•	•	•	•	•	•	•	•
56"	•	•	•	•	•	•	•	•
58"	•	•	•	•	•	•	•	•
60"	•	•	•	•	•	•	•	•

Larger sizes and high temperature sets available on request.

Unless otherwise specified, all kits will be shipped with one (1) full length insulating Mylar® sleeve, two (2) insulating phenolic washers, and two (2) zinc plated steel washers per bolt.

Flange Insulation: Jock Kits: Phenolic with Nitrile Seal Type "E" (Full Face) Gaskets

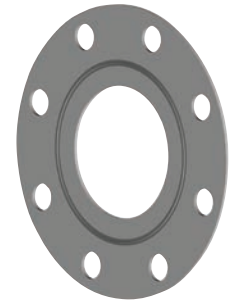

Sleeves: **Mylar® and Poly Only (•): Mylar®, Poly and Minlon® (••); Washers: Phenolic**

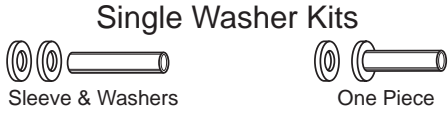

Pipe Size	SINGLE WASHER KITS						DOUBLE WASHER KITS					
	150 Class	300 Class	400 Class	600 Class	900 Class	1500 Class	150 Class	300 Class	400 Class	600 Class	900 Class	1500 Class
2"	•	•	•	•	•	•	•	•	•	•	•	•
2½"	•	•	•	•	•	•	•	•	•	•	•	•
3"	•	•	•	•	•	•	•	•	•	•	•	•
3½"	•	•	•	•			•	•	•	•		
4"	•	•	•	•	•	•	•	•	•	•	•	•
5"	•	•	•	•	•	•	•	•	•	•	•	•
6"	•	•	•	•	•	•	•	•	•	•	•	•
8"	•	•	•	•	•	•	•	•	•	•	•	•
10"	•	•	•	•	•	•	•	•	•	•	•	•
12"	•	•	•	•	•	•	•	•	•	•	•	•
14"	•	•	•	•	•	•	•	•	•	•	•	•
16"	•	•	•	•	•	•	•	•	•	•	•	•
18"	•	•	•	•	•	•	•	•	•	•	•	•
20"	•	•	•	•	•	•	•	•	•	•	•	•
22"	•	•	•	•			•	•	•	•		
24"	•	•	•	•	•	•	•	•	•	•	•	•
26"	•	•	•	•	•		•	•	•	•	•	
28"	•	•	•	•	•		•	•	•	•	•	
30"	•	•	•	•			•	•	•	•		
32"	•	•	•				•	•	•			
34"	•	•	•				•	•	•			
36"	•						•					

Larger sizes, high temperature sets (G3, G7 & G10) and custom builds available on request.

Unless otherwise specified, all kits will be shipped with one (1) full length insulating Mylar® sleeve, two (2) insulating phenolic washers, and two (2) zinc plated steel washers per bolt.

Flange Insulation: Jock Kits: Phenolic with Nitrile Seal Type "F" (Ring) Gaskets

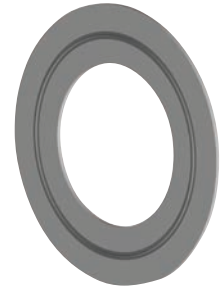

Sleeves: **Mylar® and Poly Only (•): Mylar®, Poly and Minlon® (••); Washers: Phenolic**

Single Washer Kits



Double Washer Kits

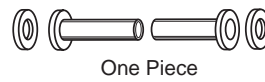

Pipe Size	SINGLE WASHER KITS						DOUBLE WASHER KITS					
	150 Class	300 Class	400 Class	600 Class	900 Class	1500 Class	150 Class	300 Class	400 Class	600 Class	900 Class	1500 Class
2"	•	•	•	•	•	•	•	•	•	•	•	•
2½"	•	•	•	•	•	•	•	•	•	•	•	•
3"	•	•	•	•	•	•	•	•	•	•	•	•
3½"	•	•	•	•			•	•	•	•		
4"	•	•	•	•	•	•	•	•	•	•	•	•
5"	•	•	•	•	•	•	•	•	•	•	•	•
6"	•	•	•	•	•	•	•	•	•	•	•	•
8"	•	•	•	•	•	•	•	•	•	•	•	•
10"	•	•	•	•	•	•	•	•	•	•	•	•
12"	•	•	•	•	•	•	•	•	•	•	•	•
14"	•	•	•	•	•	•	•	•	•	•	•	•
16"	•	•	•	•	•	•	•	•	•	•	•	•
18"	•	•	•	•	•	•	•	•	•	•	•	•
20"	•	•	•	•	•	•	•	•	•	•	•	•
22"	•	•	•	•			•	•	•	•		
24"	•	•	•	•	•	•	•	•	•	•	•	•
26"	•	•	•	•	•		•	•	•	•	•	
28"	•	•	•	•	•		•	•	•	•	•	
30"	•	•	•	•			•	•	•	•		
32"	•	•	•				•	•	•			
34"	•	•	•				•	•	•			
36"	•						•					

Larger sizes, high temperature sets (G3, G7 & G10) and custom builds available on request.

Unless otherwise specified, all kits will be shipped with one (1) full length insulating Mylar® sleeve, two (2) insulating phenolic washers, and two (2) zinc plated steel washers per bolt.

Flange Insulation: Jock Gaskets Only Type "E" (Full Face) and Type "F" (Ring)

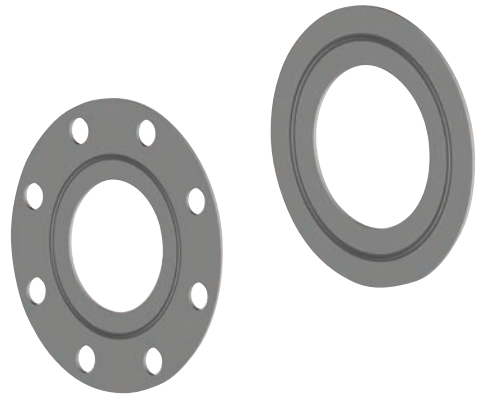

Pipe Size	TYPE "E" GASKETS						TYPE "F" GASKETS					
	150 Class	300 Class	400 Class	600 Class	900 Class	1500 Class	150 Class	300 Class	400 Class	600 Class	900 Class	1500 Class
2"	•	•	•	•	•	•	•	•	•	•	•	•
2½"	•	•	•	•	•	•	•	•	•	•	•	•
3"	•	•	•	•	•	•	•	•	•	•	•	•
3½"	•	•	•	•			•	•	•	•		
4"	•	•	•	•	•	•	•	•	•	•	•	•
5"	•	•	•	•	•	•	•	•	•	•	•	•
6"	•	•	•	•	•	•	•	•	•	•	•	•
8"	•	•	•	•	•	•	•	•	•	•	•	•
10"	•	•	•	•	•	•	•	•	•	•	•	•
12"	•	•	•	•	•	•	•	•	•	•	•	•
14"	•	•	•	•	•	•	•	•	•	•	•	•
16"	•	•	•	•	•	•	•	•	•	•	•	•
18"	•	•	•	•	•	•	•	•	•	•	•	•
20"	•	•	•	•	•	•	•	•	•	•	•	•
22"	•	•	•	•			•	•	•	•		
24"	•	•	•	•	•	•	•	•	•	•	•	•
26"	•	•	•	•	•		•	•	•	•	•	
28"	•	•	•	•	•		•	•	•	•	•	
30"	•	•	•	•			•	•	•	•		
32"	•	•	•				•	•	•			
34"	•	•	•				•	•	•			
36"	•						•					

Larger sizes, high temperature sets (G3, G7 & G10) and custom builds available on request.

Flange Insulation: RTJ: Gasket Phenolic

Sleeves: Mylar® and Poly Only (•): Mylar®, Poly and Minlon® (•);
Washers: Phenolic

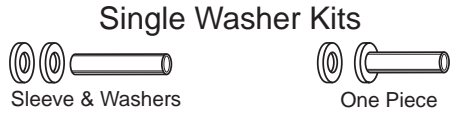

Pipe Size	SINGLE WASHER KITS						DOUBLE WASHER KITS					
	150 Class	300 Class	400 Class	600 Class	900 Class	1500 Class	150 Class	300 Class	400 Class	600 Class	900 Class	1500 Class
2"	•	•	•	•	•	•	•	•	•	•	•	•
2½"	•	•	•	•	•	•	•	•	•	•	•	•
3"	•	•	•	•	•	•	•	•	•	•	•	•
3½"	•	•	•	•			•	•	•	•		
4"	•	•	•	•	•	•	•	•	•	•	•	•
5"	•	•	•	•	•	•	•	•	•	•	•	•
6"	•	•	•	•	•	•	•	•	•	•	•	•
8"	•	•	•	•	•	•	•	•	•	•	•	•
10"	•	•	•	•	•	•	•	•	•	•	•	•
12"	•	•	•	•	•	•	•	•	•	•	•	•
14"	•	•	•	•	•	•	•	•	•	•	•	•
16"	•	•	•	•	•	•	•	•	•	•	•	•
18"	•	•	•	•	•	•	•	•	•	•	•	•
20"	•	•	•	•	•	•	•	•	•	•	•	•
22"	•	•	•	•			•	•	•	•		
24"	•	•	•	•	•	•	•	•	•	•	•	•

Larger sizes, high temperature sets and custom builds available on request.

Unless otherwise specified, all kits will be shipped with one (1) full length insulating Mylar® sleeve, two (2) insulating phenolic washers, and two (2) zinc plated steel washers per bolt.

Flange Insulation: RTJ Oval Type "D" Gasket Only

Gasket: Phenolic



RJ GASKETS						
Pipe Size	150 Class	300 Class	400 Class	600 Class	900 Class	1500 Class
2"	•	•	•	•	•	•
2½"	•	•	•	•	•	•
3"	•	•	•	•	•	•
3½"	•	•	•	•		
4"	•	•	•	•	•	•
5"	•	•	•	•	•	•
6"	•	•	•	•	•	•
8"	•	•	•	•	•	•
10"	•	•	•	•	•	•
12"	•	•	•	•	•	•
14"	•	•	•	•	•	•
16"	•	•	•	•	•	•
18"	•	•	•	•	•	•
20"	•	•	•	•	•	•
22"	•	•	•	•		
24"	•	•	•	•	•	•

Larger sizes, high temperature sets and custom builds available on request.

Flange Insulation: Durlon® Gasket Flange Insulation Kits Type "E" (Full Face)



Sleeves: Mylar® and Poly Only (•): Mylar®, Poly and Minlon® (•); Washers: Phenolic

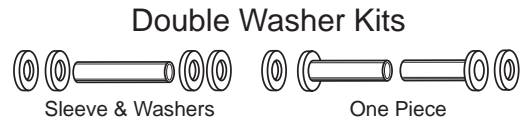
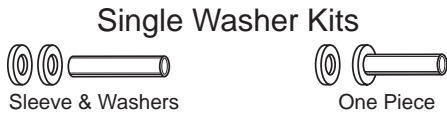

Pipe Size	SINGLE WASHER KITS						DOUBLE WASHER KITS					
	150 Class	300 Class	400 Class	600 Class	900 Class	1500 Class	150 Class	300 Class	400 Class	600 Class	900 Class	1500 Class
¾"	•	•	•	•	•	•	•	•	•	•	•	•
1"	•	•	•	•	•	•	•	•	•	•	•	•
1¼"	•	•	•	•	•	•	•	•	•	•	•	•
1½"	•	•	•	•	•	•	•	•	•	•	•	•
2"	•	•	•	•	•	•	•	•	•	•	•	•
2½"	•	•	•	•	•	•	•	•	•	•	•	•
3"	•	•	•	•	•	•	•	•	•	•	•	•
3½"	•	•	•	•	•	•	•	•	•	•	•	•
4"	•	•	•	•	•	•	•	•	•	•	•	•
5"	•	•	•	•	•	•	•	•	•	•	•	•
6"	•	•	•	•	•	•	•	•	•	•	•	•
8"	•	•	•	•	•	•	•	•	•	•	•	•
10"	•	•	•	•	•	•	•	•	•	•	•	•
12"	•	•	•	•	•	•	•	•	•	•	•	•
14"	•	•	•	•	•	•	•	•	•	•	•	•
16"	•	•	•	•	•	•	•	•	•	•	•	•
18"	•	•	•	•	•	•	•	•	•	•	•	•
20"	•	•	•	•	•	•	•	•	•	•	•	•
22"	•	•	•	•	•	•	•	•	•	•	•	•
24"	•	•	•	•	•	•	•	•	•	•	•	•
26"	•	•	•	•	•	•	•	•	•	•	•	•
28"	•	•	•	•	•	•	•	•	•	•	•	•
30"	•	•	•	•	•	•	•	•	•	•	•	•
32"	•	•	•	•	•	•	•	•	•	•	•	•
34"	•	•	•	•	•	•	•	•	•	•	•	•
36"	•	•	•	•	•	•	•	•	•	•	•	•

Larger sizes and high temperature sets available on request.

Unless otherwise specified, all kits will be shipped with one (1) full length insulating Mylar® sleeve, two (2) insulating phenolic washers, and two (2) zinc plated steel washers per bolt.

Pressure maximum is 1500 psig (103 BAR)

Flange Insulation: SPECIAL APPLICATION

Durlon® Gasket Flange Insulation Kits

Type "E" (Full Face)

Sleeves: NOMEX®; Washer: G7

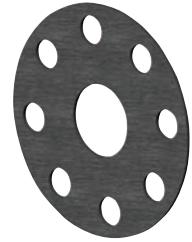

Single Washer Kits



Double Washer Kits



Pipe Size	SINGLE WASHER KITS						DOUBLE WASHER KITS					
	150 Class	300 Class	400 Class	600 Class	900 Class	1500 Class	150 Class	300 Class	400 Class	600 Class	900 Class	1500 Class
¾"	•	•	•	•	•	•	•	•	•	•	•	•
1"	•	•	•	•	•	•	•	•	•	•	•	•
1¼"	•	•	•	•	•	•	•	•	•	•	•	•
1½"	•	•	•	•	•	•	•	•	•	•	•	•
2"	•	•	•	•	•	•	•	•	•	•	•	•
2½"	•	•	•	•	•	•	•	•	•	•	•	•
3"	•	•	•	•	•	•	•	•	•	•	•	•
3½"	•	•	•	•	•	•	•	•	•	•	•	•
4"	•	•	•	•	•	•	•	•	•	•	•	•
5"	•	•	•	•	•	•	•	•	•	•	•	•
6"	•	•	•	•	•	•	•	•	•	•	•	•
8"	•	•	•	•	•	•	•	•	•	•	•	•
10"	•	•	•	•	•	•	•	•	•	•	•	•
12"	•	•	•	•	•	•	•	•	•	•	•	•
14"	•	•	•	•	•	•	•	•	•	•	•	•
16"	•	•	•	•	•	•	•	•	•	•	•	•
18"	•	•	•	•	•	•	•	•	•	•	•	•
20"	•	•	•	•	•	•	•	•	•	•	•	•
22"	•	•	•	•	•	•	•	•	•	•	•	•
24"	•	•	•	•	•	•	•	•	•	•	•	•
26"	•	•	•	•	•	•	•	•	•	•	•	•
28"	•	•	•	•	•	•	•	•	•	•	•	•
30"	•	•	•	•	•	•	•	•	•	•	•	•
32"	•	•	•	•	•	•	•	•	•	•	•	•

Larger sizes and high temperature sets available on request.

Pressure maximum is 1500 psig (103 BAR)

Flange Insulation: Durlon® Gasket Flange Insulation Kits Type "F" (Ring Gasket)



Sleeves: Mylar® and Poly Only (•): Mylar®, Poly and Minlon® (••);
Washers: Phenolic

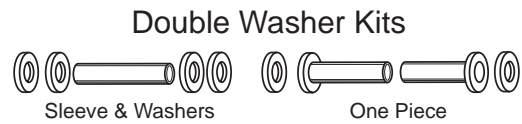
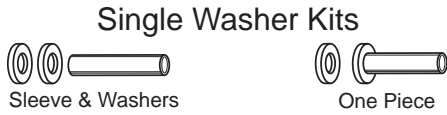

Pipe Size	SINGLE WASHER KITS						DOUBLE WASHER KITS					
	150 Class	300 Class	400 Class	600 Class	900 Class	1500 Class	150 Class	300 Class	400 Class	600 Class	900 Class	1500 Class
¾"	•	•	•	•	•	•	•	•	•	•	•	•
1"	•	•	•	•	•	•	•	•	•	•	•	•
1¼"	•	•	•	•	•	•	•	•	•	•	•	•
1½"	•	•	•	•	•	•	•	•	•	•	•	•
2"	•	•	•	•	•	•	•	•	•	•	•	•
2½"	•	•	•	•	•	•	•	•	•	•	•	•
3"	•	•	•	•	•	•	•	•	•	•	•	•
3½"	•	•	•	•	•	•	•	•	•	•	•	•
4"	•	•	•	•	•	•	•	•	•	•	•	•
5"	•	•	•	•	•	•	•	•	•	•	•	•
6"	•	•	•	•	•	•	•	•	•	•	•	•
8"	•	•	•	•	•	•	•	•	•	•	•	•
10"	•	•	•	•	•	•	•	•	•	•	•	•
12"	•	•	•	•	•	•	•	•	•	•	•	•
14"	•	•	•	•	•	•	•	•	•	•	•	•
16"	•	•	•	•	•	•	•	•	•	•	•	•
18"	•	•	•	•	•	•	•	•	•	•	•	•
20"	•	•	•	•	•	•	•	•	•	•	•	•
22"	•	•	•	•	•	•	•	•	•	•	•	•
24"	•	•	•	•	•	•	•	•	•	•	•	•
26"	•	•	•	•	•	•	•	•	•	•	•	•
28"	•	•	•	•	•	•	•	•	•	•	•	•
30"	•	•	•	•	•	•	•	•	•	•	•	•
32"	•	•	•	•	•	•	•	•	•	•	•	•
34"	•	•	•	•	•	•	•	•	•	•	•	•
36"	•	•	•	•	•	•	•	•	•	•	•	•

Larger sizes and high temperature sets available on request.

Unless otherwise specified, all kits will be shipped with one (1) full length insulating Mylar® sleeve, two (2) insulating phenolic washers, and two (2) zinc plated steel washers per bolt.

Pressure maximum is 1500 psig (103 BAR)

Flange Insulation: SPECIAL APPLICATION

Durlon® Gasket Flange Insulation Kits

Type "F" (Ring Gasket)



Sleeves: NOMEX®; Washer: G7

Single Washer Kits



Double Washer Kits



Pipe Size	SINGLE WASHER KITS						DOUBLE WASHER KITS					
	150 Class	300 Class	400 Class	600 Class	900 Class	1500 Class	150 Class	300 Class	400 Class	600 Class	900 Class	1500 Class
3/4"	•	•	•	•	•	•	•	•	•	•	•	•
1"	•	•	•	•	•	•	•	•	•	•	•	•
1 1/4"	•	•	•	•	•	•	•	•	•	•	•	•
1 1/2"	•	•	•	•	•	•	•	•	•	•	•	•
2"	•	•	•	•	•	•	•	•	•	•	•	•
2 1/2"	•	•	•	•	•	•	•	•	•	•	•	•
3"	•	•	•	•	•	•	•	•	•	•	•	•
3 1/2"	•	•	•	•	•	•	•	•	•	•	•	•
4"	•	•	•	•	•	•	•	•	•	•	•	•
5"	•	•	•	•	•	•	•	•	•	•	•	•
6"	•	•	•	•	•	•	•	•	•	•	•	•
8"	•	•	•	•	•	•	•	•	•	•	•	•
10"	•	•	•	•	•	•	•	•	•	•	•	•
12"	•	•	•	•	•	•	•	•	•	•	•	•
14"	•	•	•	•	•	•	•	•	•	•	•	•
16"	•	•	•	•	•	•	•	•	•	•	•	•
18"	•	•	•	•	•	•	•	•	•	•	•	•
20"	•	•	•	•	•	•	•	•	•	•	•	•
22"	•	•	•	•	•	•	•	•	•	•	•	•
24"	•	•	•	•	•	•	•	•	•	•	•	•
26"	•	•	•	•	•	•	•	•	•	•	•	•
28"	•	•	•	•	•	•	•	•	•	•	•	•
30"	•	•	•	•	•	•	•	•	•	•	•	•

Larger sizes and high temperature sets available on request.

Unless otherwise specified, all kits will be shipped with one (1) full length insulating Mylar® sleeve, two (2) insulating phenolic washers, and two (2) zinc plated steel washers per bolt.

Pressure maximum is 1500 psig (103 BAR)

Flange Insulation: SPECIAL APPLICATION

Durlon® Gasket Only
 Type "E" (Full Face) and
 Type "F" (Ring Gasket)

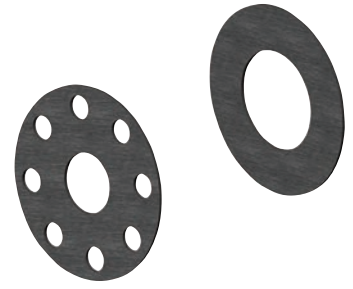

Pipe Size	TYPE "E" GASKETS						TYPE "F" GASKETS					
	150 Class	300 Class	400 Class	600 Class	900 Class	1500 Class	150 Class	300 Class	400 Class	600 Class	900 Class	1500 Class
¾"	•	•	•	•	•	•	•	•	•	•	•	•
1"	•	•	•	•	•	•	•	•	•	•	•	•
1¼"	•	•	•	•	•	•	•	•	•	•	•	•
1½"	•	•	•	•	•	•	•	•	•	•	•	•
2"	•	•	•	•	•	•	•	•	•	•	•	•
2½"	•	•	•	•	•	•	•	•	•	•	•	•
3"	•	•	•	•	•	•	•	•	•	•	•	•
3½"	•	•	•	•	•	•	•	•	•	•	•	•
4"	•	•	•	•	•	•	•	•	•	•	•	•
5"	•	•	•	•	•	•	•	•	•	•	•	•
6"	•	•	•	•	•	•	•	•	•	•	•	•
8"	•	•	•	•	•	•	•	•	•	•	•	•
10"	•	•	•	•	•	•	•	•	•	•	•	•
12"	•	•	•	•	•	•	•	•	•	•	•	•
14"	•	•	•	•	•	•	•	•	•	•	•	•
16"	•	•	•	•	•	•	•	•	•	•	•	•
18"	•	•	•	•	•	•	•	•	•	•	•	•
20"	•	•	•	•	•	•	•	•	•	•	•	•
22"	•	•	•	•	•	•	•	•	•	•	•	•
24"	•	•	•	•	•	•	•	•	•	•	•	•
26"	•	•	•	•	•	•	•	•	•	•	•	•
28"	•	•	•	•	•	•	•	•	•	•	•	•
30"	•	•	•	•	•	•	•	•	•	•	•	•
32"	•	•	•	•	•	•	•	•	•	•	•	•
34"	•	•	•	•	•	•	•	•	•	•	•	•
36"	•	•	•	•	•	•	•	•	•	•	•	•

Larger sizes and high temperature sets available on request.

Pressure maximum is 1500 psig (103 BAR)

Flange Insulation: SPECIAL APPLICATION
Large Diameter Durlon® Gasket Only
Type “E” (Full Face) and Type “F” (Ring Gasket)



Pipe Size	TYPE “E” GASKET				TYPE “F” GASKET			
	150 Class	300 Class	400 Class	600 Class	150 Class	300 Class	400 Class	600 Class
38”	•	•	•	•	•	•	•	•
40”	•	•	•	•	•	•	•	•
42”	•	•	•	•	•	•	•	•
44”	•	•	•	•	•	•	•	•
46”	•	•	•	•	•	•	•	•
48”	•	•	•	•	•	•	•	•
50”	•	•	•	•	•	•	•	•
52”	•	•	•	•	•	•	•	•
56”	•	•	•	•	•	•	•	•
58”	•	•	•	•	•	•	•	•
60”	•	•	•	•	•	•	•	•

Flange Insulation: SPECIAL APPLICATION

High Temp Sleeve and Washer Set

Sleeves: NOMEX®; Washer: G7

Single Washer Kits



Double Washer Kits



Pipe Size	SINGLE WASHER KITS						SINGLE WASHER KITS					
	150 Class	300 Class	400 Class	600 Class	900 Class	1500 Class	150 Class	300 Class	400 Class	600 Class	900 Class	1500 Class
¾"	•	•	•	•	•	•	•	•	•	•	•	•
1"	•	•	•	•	•	•	•	•	•	•	•	•
1¼"	•	•	•	•	•	•	•	•	•	•	•	•
1½"	•	•	•	•	•	•	•	•	•	•	•	•
2"	•	•	•	•	•	•	•	•	•	•	•	•
2½"	•	•	•	•	•	•	•	•	•	•	•	•
3"	•	•	•	•	•	•	•	•	•	•	•	•
3½"	•	•	•	•			•	•	•	•		
4"	•	•	•	•	•	•	•	•	•	•	•	•
5"	•	•	•	•	•		•	•	•	•	•	
6"	•	•	•	•			•	•	•	•		
8"	•	•	•	•			•	•	•	•		
10"	•	•	•	•			•	•	•	•		
12"	•	•	•	•			•	•	•	•		
14"	•	•	•				•	•	•			
16"	•	•					•	•				
18"	•	•					•	•				
20"	•	•					•	•				
22"	•	•					•	•				
24"	•						•					
26"	•						•					
28"	•						•					
30"	•						•					

Larger sizes and high temperature sets available on request.

Unless otherwise specified, all kits will be shipped with one (1) full length insulating Mylar® sleeve, two (2) insulating phenolic washers, and two (2) zinc plated steel washers per bolt.

Flange Insulation: SPECIAL APPLICATION

Jock Gasket Only

Type "E" (Full Face) and Type "F" (Ring Gasket)

Gasket: Phenolic with Viton® Seal, G3 with Viton® Seal or G10 with Viton®



Pipe Size	TYPE "E" GASKETS						TYPE "F" GASKETS					
	150 Class	300 Class	400 Class	600 Class	900 Class	1500 Class	150 Class	300 Class	400 Class	600 Class	900 Class	1500 Class
2"	•	•	•	•	•	•	•	•	•	•	•	•
2½"	•	•	•	•	•	•	•	•	•	•	•	•
3"	•	•	•	•	•	•	•	•	•	•	•	•
3½"	•	•	•	•			•	•	•	•		
4"	•	•	•	•	•	•	•	•	•	•	•	•
5"	•	•	•	•	•	•	•	•	•	•	•	•
6"	•	•	•	•	•	•	•	•	•	•	•	•
8"	•	•	•	•	•	•	•	•	•	•	•	•
10"	•	•	•	•	•	•	•	•	•	•	•	•
12"	•	•	•	•	•	•	•	•	•	•	•	•
14"	•	•	•	•	•	•	•	•	•	•	•	•
16"	•	•	•	•	•	•	•	•	•	•	•	•
18"	•	•	•	•	•	•	•	•	•	•	•	•
20"	•	•	•	•	•	•	•	•	•	•	•	•
22"	•	•	•	•			•	•	•	•		
24"	•	•	•	•	•	•	•	•	•	•	•	•
26"	•	•	•	•	•		•	•	•	•	•	
28"	•	•	•	•	•		•	•	•	•	•	
30"	•	•	•	•			•	•	•	•		
32"	•	•	•				•	•	•			
34"	•	•	•				•	•	•			
36"	•						•					

Larger sizes and high temperature sets (G3, G7 & G10) available on request.

Unless otherwise specified, all kits will be shipped with one (1) full length insulating Mylar® sleeve, two (2) insulating phenolic washers, and two (2) zinc plated steel washers per bolt.